

Luerssen 120 Podium Instructions



1. Press logo to begin.

2. Room Displays:
The front of the classroom with projector screen & monitor. The back of the classroom with rear monitor.



Room audio muted at start up.



3. Room Mode Selection:

All Displays
Projector Only
TV's Only
Audio Only



6. BluRay Controls:

Player Controls
Menu Controls
Back



4. Presentation Mode:

Select source:
Room PC DOC Cam
Blu-Ray DVD Aux HDMI
Aux Video
Video & Screen Control
Chalk Board

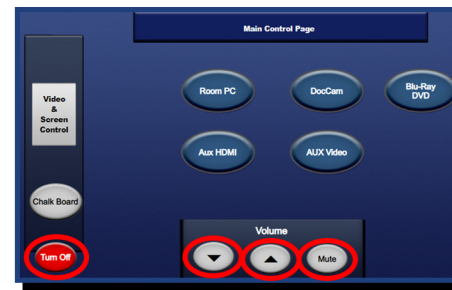

7. Room Volume Control:

Up Down & Mute
Power Down:
Turn Off Button for System Off

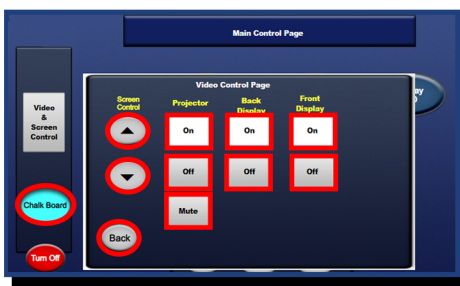

5. Video Control:

Projector & Displays (Front & Back)
On Off & Mute
Screen Up & Down
Chalk Board (Screen Up & Down)
Back

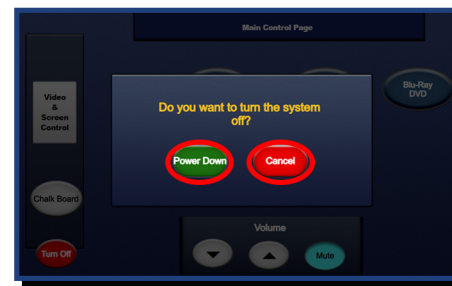

8. Power Down:
Power Down button.
Cancel Button.
Please remember to turn off room system, exit all programs, and log out of PC.

Need assistance? • Call H.E.L.P. or Ext. 4357 • Please report all problems!